



INDICE DEI PRODOTTI

PRODUCT INDEX - SOMMAIRE DES PRODUITS - PRODUKTÜBERSICHT



Cap.	Pag.	INDICE PRODOTTI
5	173	PARTICOLARI DI COLLEGAMENTO CONNECTION PARTS - PIÈCES DE LIAISON - VERSCHRAUBUNGSTEILE
5	174	PARTICOLARI DI COLLEGAMENTO CONNECTION PARTS - PIÈCES DE LIAISON - VERSCHRAUBUNGSTEILE
5	185	SILENZIATORI SILENCERS - SILENCIEUX - SCHALLDÄMPFER

CODIFICA PARTICOLARI DI COLLEGAMENTO

CONNECTION PARTS CODIFICATION - CODIFICATION PIÈCES DE LIAISON - BESTELLSYSTEM VERSCHRAUBUNGSTEILE

REGOLA GENERALE - GENERAL RULE - RÈGLE GÉNÉRALE - ALLGEMEINE REGEL

- La codifica SISTEM PNEUMATICA si pone al cliente con una metodologia "parlante", in cui vengono suddivise le zone di composizione del codice stesso, rendendolo così di rapida lettura, memorizzazione ed individuazione.
- The SISTEM PNEUMATICA coding is put to the customers with a "talking" system, where you hypothetically divide the parts which compose the code as well, so it becomes easy to read, memorize and individuate
- La codification SISTEM PNEUMATICA se pose au client avec une méthodologie « parlante » où les parts qui composent le code même hypothétiquement sont divisés, ainsi il sera de plus facile lecture, mémorisation et repérage.
- Sistem Pneumatica hat einen systematischen, "selbstsprechenden" Bestellcode. Hier haben bestimmte Zahlen an einer bestimmten Stelle immer dieselbe Aussage über die Verschraubung, bezogen auf Bauform und Größe

FILETTO THREAD - FILET - GEWINDE		TUBO TUBE - TUBE - SCHLAUCH	TIPO FILETTO THREAD TYPE - TYPE DE FILET - GEWINDEART	
5 M5	8 1/8"	04 tubo Ø4	0 CONICO+TEFLON TAPERED+PTFE CONIQUE+TEFLON KONISCH+TEFLON	7 Cilindrico "EASY"+OR PARALLÈL+OR CYLINDRIQUE+OR ZYLINDRISCH+OR
6 M6x0,75	4 1/4"	05 tubo Ø5	0 CONICO NPT NPT TAPERED CONIQUE NPT KONISCH NPT	9 CILINDRICO PARALLELO CYLINDRIQUE ZYLINDRISCH
61 M6x1	3 3/8"	06 tubo Ø6	0 CILINDRICO FEMMINA FEMALE PARALLEL CYLINDRIQUE FEMELLE ZYLINDRISCH FEMINEN	8 METRICO+OR METRIC+OR METRIQUE+OR METRISCH+OR
81 M8x1	2 1/2"	08 tubo Ø8		
1212 M12x1,25	K 1/8" NPT	10 tubo Ø10		
1215 M12x1,5	X 1/4" NPT	12 tubo Ø12		
	Y 3/8" NPT	14 tubo Ø14		
	Z 1/2" NPT	15 tubo Ø15		



SCHEDA TECNICA PARTICOLARI DI COLLEGAMENTO

CONNECTION PARTS SPECIFICATION SHEET - FICHE TECHNIQUE PIÈCE DE LIAISON - VERSCHRAUBUNGSTEILE TECHNISCHES BLATT

CARATTERISTICHE TECNICHE PRINCIPALI

MAIN TECHNICAL FEATURES - PRINCIPALES CARACTERISTIQUES TECHNIQUES - MAIN TECHNISCHE DATEN

MATERIALI DI COSTRUZIONE:
OTTONE NICHELATO (EN 12164 - CW614N) - ZAMA-15 NICHELATA (UNI EN 1774:99) - ALLUMINIO

PRESSIONE MAX D'ESERCIZIO:
16 BAR (1,6 MPa)

TEMPERATURA DI LAVORO:
-10°C (263°K), +80°C (353°K)

MATERIALS OF CONSTRUCTION:
NICKEL-PLATED BRASS (EN 12164 - CW617N) - NICKEL-PLATED ZAMA-15 (UNI EN 1774:99) - ALUMINIUM

MAX WORKING PRESSURE:
16 BAR (1,6 MPa)

WORKING TEMPERATURE:
-10°C (263°K), +80°C (353°K)

MATERIEL DE FABRICATION:
LAITON NICKÉ (EN 12164 - CW617N) - ZAMA-15 NICKÉ (UNI EN 1774:99) - ALUMINIUM

PRESSION MAXI D'EXERCICE:
16 BAR (1,6 MPa)

TEMPERATURE DE TRAVAIL:
-10°C (263°K), +80°C (353°K)

HERSTELLUNGSMATERIAL:
MESSING VERNICKELT (EN 12164 - CW617N) - ZAMAK-15 VERNICKELT (UNI EN 1774:99) - ALUMINIUM

HÖCHSTBETRIEBSDRUCK:
16 BAR (1,6 MPa)

BETRIEBSTEMPERATUREN:
-10°C (263°K), +80°C (353°K)



O-RING/GUARNIZIONI RUBBER - JOINTS - DICHTUNGEN



GUARNIZIONI IN GOMMA ANTIOILIO NBR, ESENTI DA SILICONE
OIL-PROOF RUBBER PACKINGS NBR, SILICON FREE
JOINTS EN CAOUTCHOUC ANTI-HUILE NBR, LIBRES DE SILICONE
DICHTUNGEN NBR, ÖLBESTÄNDIG, SILICONFREI

O-RING SPECIALI A RICHIESTA
SPECIAL O-RINGS ON REQUEST
JOINTS SPECIAUX SUR DEMANDE
ANDERE DICHTUNGEN AUF ANFRAGE

TIPOLOGIE DI FILETTO THREADED TYPE - CONNEXION FILETÉE - GEWINDENSCHLUSS



FILETTO CILINDRICO/METRICO
PARALLEL/METRIC THREAD
FILET CYLINDRIQUE/METRIQUE
ZYLINDRISCHES/METRISCHES GEWINDE
UNI-ISO 228/1 UNI 5542-65



FILETTO CONICO
TAPERED THREAD
FILET CONIQUE
KONISCHES GEWINDE
UNI-ISO 7/1



FILETTO CILINDRICO FEMMINA
FEMALE PARALLEL THREAD
FILET CYLINDRIQUE FEMELLE
ZYLINDRISCHES INNENGEWINDE
UNI-ISO 228/1

S10

NIPPLO CONICO
 TAPERED NIPPLE
 MAMELON CONIQUE
 DOPPELNIPPEL

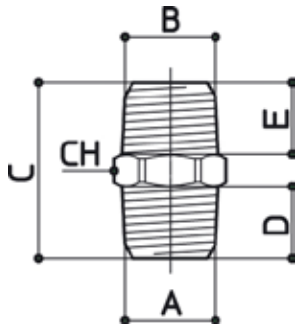

CODICE	A	B	C	D	E	F	G	CH	CH1	GR
S10880	R1/8	R1/8	21	8	8			12		9
S10840	R1/8	R1/4	23	8	10			14		13
S10440	R1/4	R1/4	25	10	10			14		14
S10830	R1/8	R3/8	25	8	11			17		20
S10430	R1/4	R3/8	27	10	11			17		24
S10330	R3/8	R3/8	28	11	11			17		26
S10420	R1/4	R1/2	30	10	14			22		36
S10320	R3/8	R1/2	31	11	14			22		39
S10220	R1/2	R1/2	34	14	14			22		42
S10270	R1/2	R3/4	37	14	16.5			27		67
S10770	R3/4	R3/4	39.5	16.5	16.5			27		80
S10710	R3/4	R1	42.5	16.5	19			34		105
S10110	R1	R1	45	19	19			34		127

S11

NIPPLO CILINDRICO
 PARALLEL NIPPLE
 MAMELON CYLINDRIQUE
 DOPPELNIPPEL

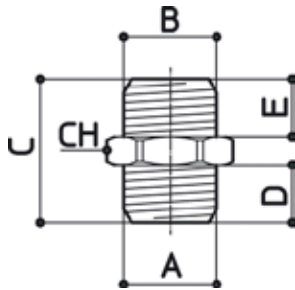

CODICE	A	B	C	D	E	F	G	CH	CH1	GR
S11580	M5	G1/8	14.5	4	6			14		9
S11880	G1/8	G1/8	17	6	6			14		9
S11840	G1/8	G1/4	19	6	8			17		15
S11440	G1/4	G1/4	21	8	8			17		17
S11830	G1/8	G3/8	22	6	10			20		25
S11430	G1/4	G3/8	24	8	10			20		25
S11330	G3/8	G3/8	26	10	10			20		28
S11420	G1/4	G1/2	26	8	12			24		36
S11320	G3/8	G1/2	28	10	12			24		39
S11220	G1/2	G1/2	30	12	12			24		39
S11270	G1/2	G3/4	27.5	10	11			30		66
S11770	G3/4	G3/4	28.5	11	11			30		60

S12

PROLUNGA CONICA
 TAPERED EXTENSION
 RALLONGE CONIQUE
 GERADER ÜBERGANGSTUTZEN

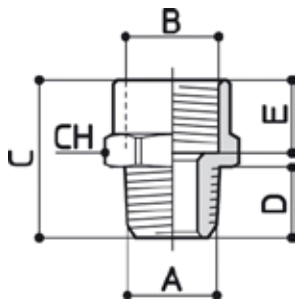

CODICE	A	B	C	D	E	F	G	CH	CH1	GR
S12880	R1/8	G1/8	20	8	8			14		12
S12480	R1/4	G1/8	23	10	8			17		15
S12840	R1/8	G1/4	23	8	10			17		18
S12440	R1/4	G1/4	24	10	10			17		19
S12340	R3/8	G1/4	25	11	10			22		39
S12830	R1/8	G3/8	23	8	11			22		30
S12430	R1/4	G3/8	25	10	11			22		31
S12330	R3/8	G3/8	27	11	11			22		35
S12230	R1/2	G3/8	32	14	11			22		43
S12420	R1/4	G1/2	29	10	13			24		38
S12320	R3/8	G1/2	30	11	13			26		52
S12220	R1/2	G1/2	33	14	13			26		54
S12270	R1/2	G3/4	35	14	16.5			32		82

S13

PROLUNGA CILINDRICA
 PARALLEL EXTENSION
 RALLONGE CYLINDRIQUE
 GERADER ÜBERGANGSTUTZEN

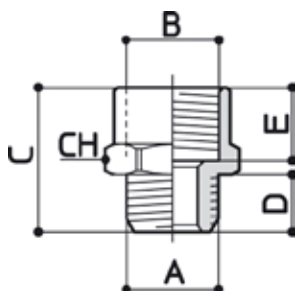

CODICE	A	B	C	D	E	F	G	CH	CH1	GR
S13580	M5	G1/8	14.5	4	8			14		9
S13880	G1/8	G1/8	18	6	8			14		11
S13480	G1/4	G1/8	21	8	8			17		16
S13840	G1/8	G1/4	21	6	10			17		18
S13440	G1/4	G1/4	22	8	10			17		18
S13340	G3/8	G1/4	24	10	10			22		30
S13430	G1/4	G3/8	24	8	11			22		30
S13330	G3/8	G3/8	26	10	11			22		35
S13230	G1/2	G3/8	30	12	11			26		56
S13320	G3/8	G1/2	28	10	13			26		52
S13220	G1/2	G1/2	31	12	13			26		50

PARTICOLARI DI COLLEGAMENTO

CONNECTION PARTS - PIÈCES DE LIAISON - VERSCHRAUBUNGSTEILE

S14

RIDUZIONE CONICA
TAPERED REDUCTION
REDUCTION CONIQUE
KEGELFORMIGE REDUZIERUNG

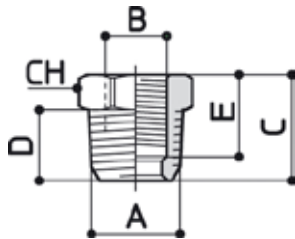

CODICE	A	B	C	D	E	F	G	CH	CH1	GR
S14850	R1/8	M5	12	8	6			12		7
S14480	R1/4	G1/8	14	10	10			14		9
S14380	R3/8	G1/8	17	11	11			17		20
S14280	R1/2	G1/8	19.5	14	8			22		35
S14340	R3/8	G1/4	17	11	10			17		14
S14240	R1/2	G1/4	22	14	12			22		33
S14230	R1/2	G3/8	22	14	12			22		22
S14730	R3/4	G3/8	23	16.5	11			27		67
S14720	R3/4	G1/2	23	16.5	14			27		52

S15

RIDUZIONE CILINDRICA
CYLINDRICAL REDUCTION
REDUCTION CYLINDRIQUE
ZYLINDRISCHE REDUZIERUNG

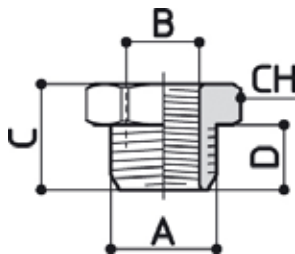

CODICE	A	B	C	D	E	F	G	CH	CH1	GR
S15850	G1/8	M5	11	6				14		9
S15480	G1/4	G1/8	13	8				17		11
S15380	G3/8	G1/8	16	10				22		28
S15280	G1/2	G1/8	15.5	10				24		39
S15340	G3/8	G1/4	16	10				22		20
S15240	G1/2	G1/4	19	12				26		44
S15230	G1/2	G3/8	19	12				26		32
S15730	G3/4	G3/8	17.5	11				30		54
S15720	G3/4	G1/2	17.5	11				30		41

S15

RIDUZIONE CILINDRICA+OR
CYLINDRICAL REDUCTION+O-RING
REDUCTION CYLINDRIQUE+O-RING
ZYLINDRISCHE REDUZIERUNG+O-RING

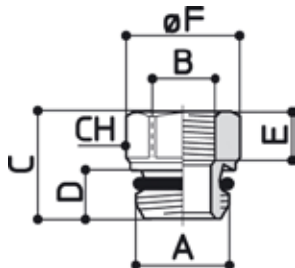

CODICE	A	B	C	D	E	F	G	CH	CH1	GR
S15487	G1/4	G1/8	13.5	6	6	15.7		14		10
S15347	G3/8	G1/4	20	8	8.5	20		18		22
S15247	G1/2	G1/4	16.5	9	16.5	24		22		29
S15237	G1/2	G3/8	23.5	9	10	24		22		37

S16

MANICOTTO FEMMINA
FEMALE SLEEVE
MANCHON FEMELLE
MUFFE

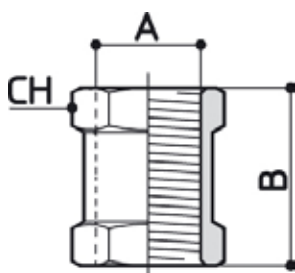

CODICE	A	B	C	D	E	F	G	CH	CH1	GR
S16050	M5	11						8		3
S16080	G1/8	18						14		12
S16040	G1/4	22						17		19
S16030	G3/8	26						22		34
S16020	G1/2	30						26		55
S16070	G3/4	33						32		82

PARTICOLARI DI COLLEGAMENTO

CONNECTION PARTS - PIÈCES DE LIAISON - VERSCHRAUBUNGSTEILE

S17

MANICOTTO RIDUZIONE FEMMINA
FEMALE REDUCTION SLEEVE
MANCHON REDUCTION FEMELLE
REDUZIERMUFFE

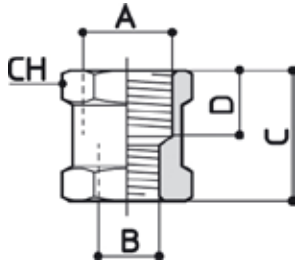

CODICE	A	B	C	D	E	F	G	CH	CH1	GR
S17850	G1/8	M5	13.5	8				14		8
S17480	G1/4	G1/8	19	10				17		20
S17380	G3/8	G1/8	20	12				22		40
S17340	G3/8	G1/4	23	12				22		42
S17240	G1/2	G1/4	25	14				26		63
S17230	G1/2	G3/8	28	14				26		64
S17720	G3/4	G1/2	30	16.5				32		78

S18

PROLUNGA CILINDRICA LUNGA
LONG CYLINDRICAL EXTENSION
RALLONGE CYLINDRIQUE
ZYLINDRISCHE VERLÄNGERUNG

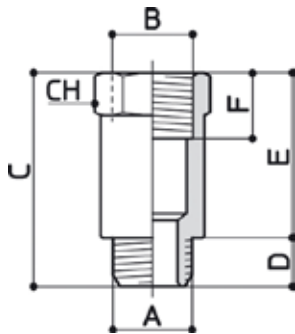

CODICE	A	B	C	D	E	F	G	CH	CH1	GR
S18816	G1/8	G1/8	22	6	16	8		14		15
S18836	G1/8	G1/8	42	6	36	8		14		30
S18427	G1/4	G1/4	35	8	27	10		17		32
S18443	G1/4	G1/4	51	8	43	10		17		47

S19

TAPPO CILINDRICO
CYLINDRICAL PLUG
BOUCHON CYLINDRIQUE
MESSING-STOPFEN MIT AUSSENSECHSKANT

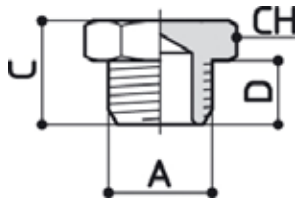

CODICE	A	B	C	D	E	F	G	CH	CH1	GR
S19050	M5		7.5	4				8		2
S19080	G1/8		11	6				14		9
S19040	G1/4		13	8				17		14
S19030	G3/8		15	10				19		22
S19020	G1/2		16	10				24		34
S19070	G3/4		16.5	11				30		49
S19010	G1		19	13				38		77

S19

TAPPO CILINDRICO+OR
CYLINDRICAL PLUG+O-RING
BOUCHON CYLINDRIQUE+O-RING
MESSING-STOPFEN MIT AUSSENSECHSKANT+OR

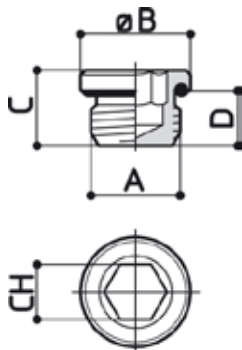

CODICE	A	B	C	D	E	F	G	CH	CH1	GR
S19058	M5	8	6	4				2,5		1
S19088	G1/8	13	9	6				6		4
S19048	G1/4	16	11	8				8		8
S19038	G3/8	20	14	10				10		17
S19028	G1/2	25	16	12				12		30

PARTICOLARI DI COLLEGAMENTO

CONNECTION PARTS - PIÈCES DE LIAISON - VERSCHRAUBUNGSTEILE

S20

TAPPO FEMMINA
FEMALE PLUG
BOUCHON FEMELLE
VERSCHLUSS KA

CODICE	A	B	C	D	E	F	G	CH	CH1	GR
S20080	G1/8	12	12					13		9
S20040	G1/4	13	13.5					17		16
S20030	G3/8	16	16					21		29
S20020	G1/2	18	18					26		47

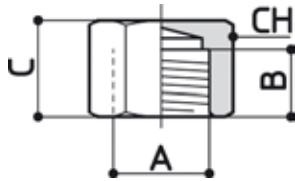

S25

TAPPO CONICO CON BRUGOLA
TAPERED PLUG WITH SOCKET HEAD SCREW
BOUCHON CONIQUE AVEC 6 PANS CREUX
STOPFEN MIT INNENSECHSKANT, KONISCH

CODICE	A	B	C	D	E	F	G	CH	CH1	GR
S25080	R1/8			7.5				5		3
S25040	R1/4			10				6		8
S25030	R3/8			11				8		14
S25020	R1/2			13				10		25

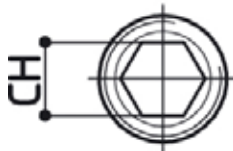
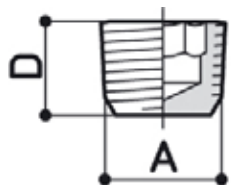

S21

RESCA PORTAGOMMA CILINDRICA
PARALLEL HOSE TAIL
DOUILLE CANNELEE CYLINDRIQUE
EINSCHRAUBTÜLE, ZYLINDRISCH

CODICE	A	B	C	D	E	F	G	CH	CH1	GR
S21086	G1/8	6	29.5	6				12		8
S21046	G1/4	6	32	8				14		13
S21087	G1/8	7	29.5	v6				12		9
S21047	G1/4	7	31.5	8				14		13
S21088	G1/8	8	29.5	6				12		9
S21048	G1/4	8	32.5	8				14		13
S21038	G3/8	8	34	9				19		24
S21089	G1/8	9	29.5	6				12		9
S21049	G1/4	9	31.5	8				14		14
S21039	G3/8	9	34	9				19		22
S21081	G1/8	10	30.5	6				12		10
S21041	G1/4	10	32.5	8				14		15
S21031	G3/8	10	34	9				19		23
S21042	G1/4	12	32.5	8				14		16
S21032	G3/8	12	34	9				19		24
S21022	G1/2	12	36	10				22		32
S21044	G1/4	14	43	9				15		28
S21034	G3/8	14	34	9				19		28
S21024	G1/2	14	37.5	10				22		34
S21037	G3/8	17	38.5	9				19		30
S21027	G1/2	17	39.5	10				22		38
S21718	G3/4	18	41	11				30		60
S21220	G1/2	20	39.5	10				22		40
S21720	G3/4	20	42	11				30		58

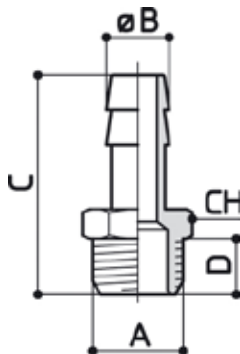

PARTICOLARI DI COLLEGAMENTO

CONNECTION PARTS - PIÈCES DE LIAISON - VERSCHRAUBUNGSTEILE

S26

RESCA PORTAGOMMA CILINDRICA+OR
PARALLEL HOSE TAIL+OR
DOUILLE CANNELEE CYLINDRIQUE+OR
EINSCHRAUBTÜLLE, ZYLINDRISCH MIT O-RING

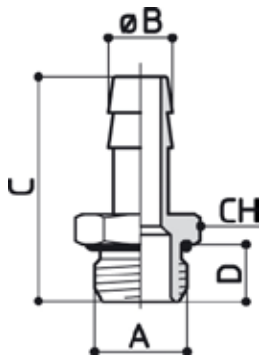

CODICE	A	B	C	D	E	F	G	CH	CH1	GR
S26086	G1/8	6	29.5	6				14		10
S26046	G1/4	6	32	8				17		15
S26087	G1/8	7	29.5	6				14		11
S26047	G1/4	7	32	8				17		16
S26088	G1/8	8	29.5	6				14		11
S26089	G1/8	9	29.5	6				14		12
S26049	G1/4	9	32	8				17		17
S26039	G3/8	9	33	9				20		38
S26042	G1/4	12	33	8				17		19
S26032	G3/8	12	34	9				20		24
S26022	G1/2	12	35.5	10				25		37
S26037	G3/8	17	38	9				20		30
S26027	G1/2	17	39.5	10				24		43

S31

RESCA PORTAGOMMA L CONICA
TAPERED ELBOW RUBBER HOSE END
DOUILLE CANNELEE CONIQUE L
WINKELTÜLLE MIT AUßENGEWINDE

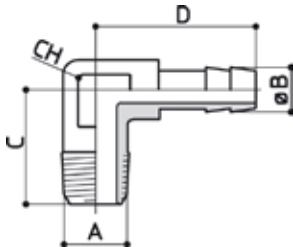

CODICE	A	B	C	D	E	F	G	CH	CH1	GR
S31860	R1/8	6	18.5	22.5				8		10
S31806	R1/8	6	23	22.5				8		12
S31460	R1/4	6	23	23				9		16
S31870	R1/8	7	18.5	22.5				8		10
S31807	R1/8	7	23	22.5				8		11
S31470	R1/4	7	23	23				9		16

S27

RESCA PORTAGOMMA METRICA+OR
METRIC RUBBER HOSE END+OR
DOUILLE CANNELEE CONIQUE L
GERADER EINSCHRAUBVERBINDER+OR

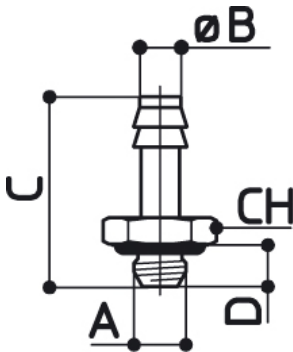

CODICE	A	B	C	D	E	F	G	CH	CH1	GR
S27328	M3	2	16	3				6		2
S27528	M5	2	17	4				8		2
S27538	M5	3	17	4				8		2
S27548	M5	4	18	4				8		2

S28

RESCA PORTAGOMMA INTERMEDIA
INTERMEDIATE RUBBER HOSE END
DOUILLE CANNELEE UNION
GERADER VERBINDER

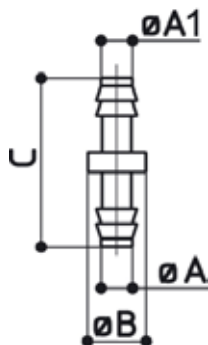

CODICE	A	B	C	D	E	F	G	CH	CH1	GR
S28220	2	2	5	22						1
S28320	3	2	6	22						1
S28330	3	3	6	22						2
S28430	4	3	7	23						2
S28440	4	4	7	24						2
S28640	6	4	9	24						3
S28660	6	6	9	24						4

5 PARTICOLARI DI COLLEGAMENTO - CONNECTION PARTS - PIÈCES DE LIAISON - VERSCHRAUBUNGSTEILE

PARTICOLARI DI COLLEGAMENTO

CONNECTION PARTS - PIÈCES DE LIAISON - VERSCHRAUBUNGSTEILE

S29

RESCA PORTAGOMMA INTERMEDIA-L
 INTERMEDIATE ELBOW RUBBER HOSE END
 DOUILLE CANNELEE EQUERRE
 WINKEL-VERBINDER

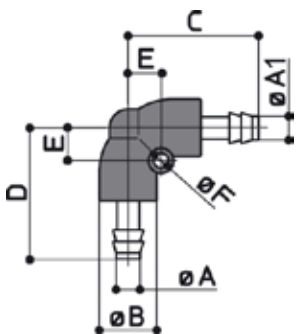

CODICE	A	B	C	D	E	F	G	CH	CH1	GR
S29220	2	2	10	22	22	5.7	2.7			6
S29330	3	3	10	22	22	5.7	2.7			6
S29440	4	4	10	22	22	5.7	2.7			7
S29660	6	6	10	22	22	5.7	2.7			7

S30

RESCA PORTAGOMMA INTERMEDIA-T
 INTERMEDIATE TEE RUBBER HOSE END
 DOUILLE CANNELEE T
 T-VERBINDER

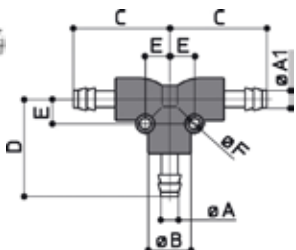

CODICE	A	B	C	D	E	F	G	CH	CH1	GR
S30220	2	2	10	22	22	5.7	2.7			9
S30330	3	3	10	22	22	5.7	2.7			9
S30440	4	4	10	22	22	5.7	2.7			11
S30660	6	6	10	22	22	5.7	2.7			11

S22

RIPARTITORE 4 VIE
 4WAYS MULTIPLE COLLECTOR
 REPARTITEUR 4 VOIES
 4-WEGE VERTEILER BLOCK

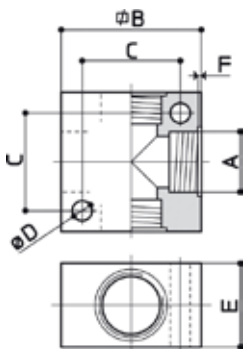

CODICE	A	B	C	D	E	F	G	CH	CH1	GR
S22080	G1/8	25	17	4.5	15	0.5				17
S22040	G1/4	30	23	4.5	18	-				28
S22340	G1/4	40	26	5.5	20	0.5				63
S22030	G3/8	50	34	5.5	25	0.5				124
S22020	G1/2	50	34	5.5	30	0.5				135

S23

RACCORDO RIDOTTO-L fil. M.F.
 REDUCED ELBOW FITTING M.F.
 RACCORD REDUIT-L. M.F.
 L-VERSCHRAUBUNG, INNEN-AUSSENGEWINDE

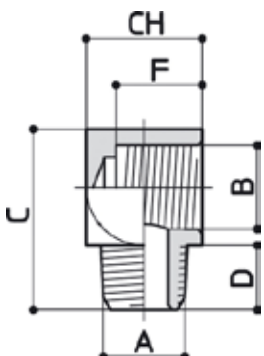

CODICE	A	B	C	D	E	F	G	CH	CH1	GR
S23550	M5	M5	16	5		5		9		6
S23880	R1/8	G1/8	22	8		9		14		18
S23440	R1/4	G1/4	28	10		10		18		36

PARTICOLARI DI COLLEGAMENTO

CONNECTION PARTS - PIÈCES DE LIAISON - VERSCHRAUBUNGSTEILE

S24

RACCORDO RIDOTTO-T fil. M.F.
REDUCED TEE FITTING M.F.
RACCORD REDUIT-T M.F.
T-VERSCHRAUBUNG, INNEN-AUSSENGEWINDE

CODICE	A	B	C	D	E	F	G	CH	CH1	GR
Z24880	R1/8	G1/8	22	8				14		16
Z24440	R1/4	G1/4	28	10				18		34

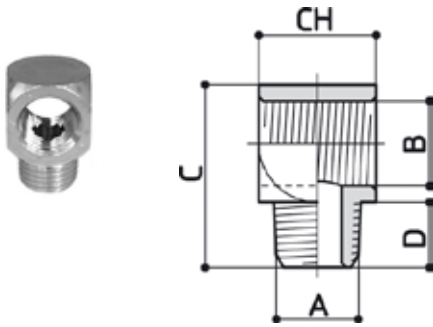

Z30

RACCORDO-L fil. M.F.
ELBOW FITTING M.F.
RACCORD-L M.F.
SCHRAUB-MUFFEN-WINKEL

CODICE	A	B	C	D	E	F	G	CH	CH1	GR
Z30550	M5	M5	11.5	11	8.5	5		9		7
Z30880	R1/8	G1/8	18.5	21	13	8		11		17
Z30440	R1/4	G1/4	23	24.5	17	10		13		35
Z30330	R3/8	G3/8	26	28	21	11		17		50
Z30220	R1/2	G1/2	31.5	35	26.5	14		20		89
Z30770	R3/4	G3/4	33	36.5	32	16.5		25		124
Z30110	R1	G1	45	39	39	19		30		213

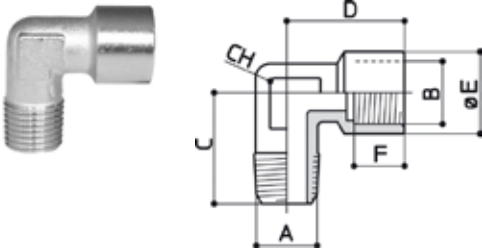

Z31

RACCORDO-L fil. F.F.
ELBOW FITTING F.F.
RACCORD-L F.F.
WINKEL-MUFFENANSCHLUSS

CODICE	A	B	C	D	E	F	G	CH	CH1	GR
Z31550	M5	M5	11	8.5	5			9		9
Z31880	G1/8	G1/8	21	13	8			11		18
Z31440	G1/4	G1/4	24.5	17	10			13		40
Z31330	G3/8	G3/8	28	21	11			17		62
Z31220	G1/2	G1/2	35	26.5	14			20		107
Z31770	G3/4	G3/4	36.5	32	16.5			25		144
Z31110	G1	G1	45	39	19			30		234

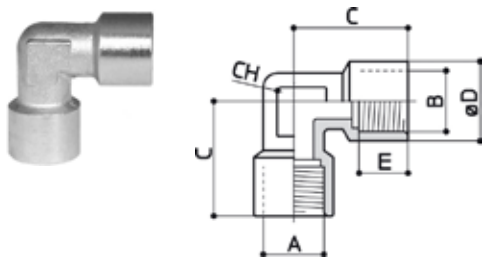

Z32

RACCORDO-L fil. M.M.
ELBOW FITTING M.M.
RACCORD-L M.M.
WINKEL-SCHRAUBANSCHLUSS

CODICE	A	B	C	D	E	F	G	CH	CH1	GR
Z32550	M5	M5	11.5	11.5				9		8
Z32880	R1/8	R1/8	18.5	18.5				11		13
Z32440	R1/4	R1/4	23	23				13		28
Z32330	R3/8	R3/8	26	26				17		37
Z32220	R1/2	R1/2	31.5	31.5				20		72
Z32770	R3/4	R3/4	33	33				25		99
Z32110	R1	R1	39	39				30		174

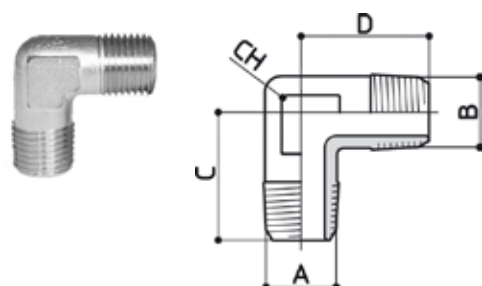

PARTICOLARI DI COLLEGAMENTO

CONNECTION PARTS - PIÈCES DE LIAISON - VERSCHRAUBUNGSTEILE

Z33

RACCORDO-T fil. F.M.F.
TEE CENTRAL FITTING F.M.F.
RACCORD-T CENTR. F.M.F.
T-EINSCHRAUB-DOPPELMUFFENANSCHLUSS

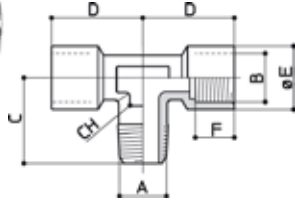

CODICE	A	B	C	D	E	F	G	CH	CH1	GR
Z33050	M5	M5	11.5	11	8.5	5		9		10
Z33080	R1/8	G1/8	18.5	21	13	8		11		24
Z33040	R1/4	G1/4	23	24.5	17	10		13		52
Z33030	R3/8	G3/8	1	28	21	11		17		76
Z33020	R1/2	G1/2	31.5	35	26.5	14		20		130
Z33070	R3/4	G3/4	33	36.5	32	16.5		25		178
Z33010	R1	G1	39	45	39	19		30		295

Z34

RACCORDO-T fil. F.F.F.
TEE FITTING F.F.F.
RACCORD-T EFF.
T-SCHRAUBANSCHLUSS INNENGEWINDE

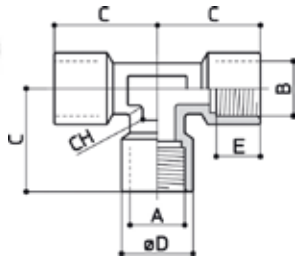

CODICE	A	B	C	D	E	F	G	CH	CH1	GR
Z34050	M5	M5	11	8.5	5			9		9
Z34080	G1/8	G1/8	21	13	8			11		28
Z34040	G1/4	G1/4	24.5	17	10			13		57
Z34030	G3/8	G3/8	28	21	11			17		85
Z34020	G1/2	G1/2	34.5	26.5	14			20		145
Z34070	G3/4	G3/4	36.5	32	16.5			25		193
Z34010	G1	G1	45	39	19			30		327

Z35

RACCORDO-T fil. M.M.M.
TEE FITTING M.M.M.
RACCORD-T M.M.M.
T-SCHRAUBANSCHLUSS AUSSENGEWINDE

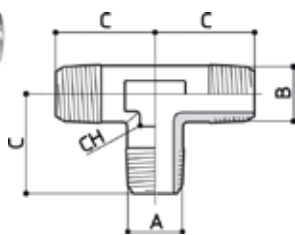

CODICE	A	B	C	D	E	F	G	CH	CH1	GR
Z35080	R1/8	R1/8	18.5					11		17
Z35040	R1/4	R1/4	23					13		38
Z35030	R3/8	R3/8	26					17		50
Z35020	R1/2	R1/2	31.5					20		97
Z35070	R3/4	R3/4	33					25		134
Z35010	R1	R1	39					30		236

Z36

RACCORDO-T fil. M.F.F.
LATERAL TEE FITTING M.F.F.
RACCORD-T LATÉR M.F.F.
L-SCHRAUB-DOPPELMUFFENANSCHLUSS (T-Körper)

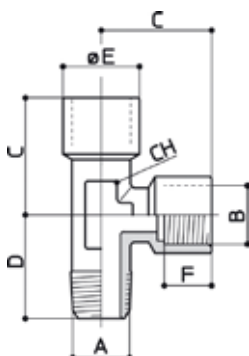

CODICE	A	B	C	D	E	F	G	CH	CH1	GR
Z36050	M5	M5	11	11.5	8.5	5		9		9
Z36080	R1/8	G1/8	21	18	13	8		11		25
Z36040	R1/4	G1/4	24.5	23.5	17	10		13		50
Z36030	R3/8	G3/8	26	26	21	11		17		64
Z36020	R1/2	G1/2	31	31	26.5	14		20		129
Z36070	R3/4	G3/4	36.5	33	32	16.5		25		178
Z36010	R1	G1	45	39	39	19		30		289

PARTICOLARI DI COLLEGAMENTO

CONNECTION PARTS - PIÈCES DE LIAISON - VERSCHRAUBUNGSTEILE

Z37

RACCORDO-T fil. M.F.M.
TEE FITTING M.F.M.
RACCORD-T M.F.M.
T-AUFSCRAUB-ANSCHLUSS MIT 2. AUSSENGEWINDE

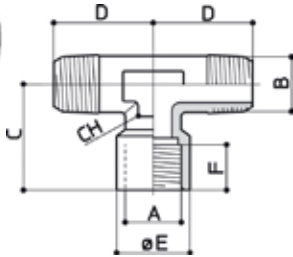

CODICE	A	B	C	D	E	F	G	CH	CH1	GR
Z37080	G1/8	R1/8	21	18.5	13	8		11		20
Z37040	G1/4	R1/4	24.5	23	17	10		13		44
Z37030	G3/8	R3/8	28	26	21	11		17		66
Z37020	G1/2	R1/2	35	31.5	26.5	14		20		114
Z37070	G3/4	R3/4	36.5	33	32	16.5		25		157
Z37010	G1	R1	45	39	39	19		30		263

Z42

RACCORDO-T fil. M.F.F.
TEE FITTING M.F.F.
RACCORD-T M.F.F.
L-AUFSCRAUBVERSCHRAUBUNG

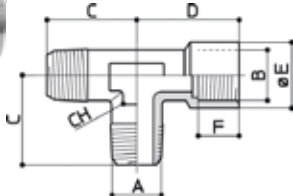

CODICE	A	B	C	D	E	F	G	CH	CH1	GR
Z42080	R1/8	G1/8	18.5	20	13	8		10		21
Z42040	R1/4	G1/4	23.5	25.5	17	10		13		42
Z42030	R3/8	G3/8	26	28	21	11		17		64
Z42020	R1/2	G1/2	31	33.5	26.5	14		20		110
Z42070	R3/4	G3/4	33	36.5	32	16.5		25		153
Z42010	R1	G1	39	45	39	19		30		270

Z38

RACCORDO-X fil. M.F.F.F.
CROSS FITTING M.F.F.F.
RACCORD EN CROIX M.F.F.F.
KREUZ-SCHRAUB-MUFFENANSCHLUSS

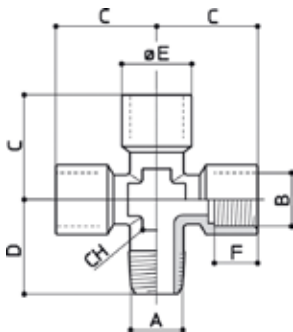

CODICE	A	B	C	D	E	F	G	CH	CH1	GR
Z38080	R1/8	G1/8	21	18	13	8		11		33
Z38040	R1/4	G1/4	24.5	23.5	17	10		13		68
Z38030	R3/8	G3/8	28	26	21	11		17		100
Z38020	R1/2	G1/2	33.5	31	26.5	14		21		169

Z41

RACCORDO-X fil. F.F.F.F.
CROSS FITTING F.F.F.F.
RACCORD EN CROIX F.F.F.F.
KREUZ-MUFFENANSCHLUSS

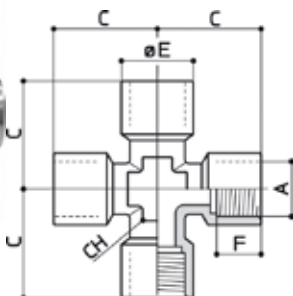

CODICE	A	B	C	D	E	F	G	CH	CH1	GR
Z41080	G1/8		21		13	8		10		37
Z41040	G1/4		25.5		17	11		13		74
Z41030	G3/8		28		21	11.5		17		110
Z41020	G1/2		33.5		26.5	14		21		186

PARTICOLARI DI COLLEGAMENTO

CONNECTION PARTS - PIÈCES DE LIAISON - VERSCHRAUBUNGSTEILE

Z39

RACCORDO-Y fil. F.M.F.
Y FITTING F.M.F.
RACCORD-Y F.M.F.
Y-SCHRAUB-MUFFEN-ANSCHLUSS

CODICE	A	B	C	D	E	F	G	CH	CH1	GR
Z39880	R1/8	G1/8	13.5	8	8			11		22
Z39440	R1/4	G1/4	17.5	10	10			13		38
Z39330	R3/8	G3/8	21	11	11			17		53
Z39220	R1/2	G1/2	26	14	14			20		107

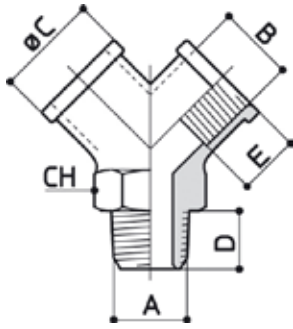

Z40

RACCORDO-Y fil. F.F.F.
Y FITTING F.F.F.
RACCORD-Y F.F.F.
Y-MUFFENANSCHLUSS

CODICE	A	B	C	D	E	F	G	CH	CH1	GR
Z40880	G1/8	G1/8	13.5	8				14		18
Z40440	G1/4	G1/4	17.5	10				17		33
Z40330	G3/8	G3/8	21	11				20		46
Z40220	G1/2	G1/2	26	14				25		94

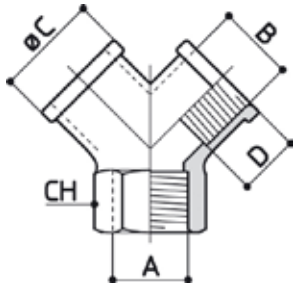



SFE

SILENZIATORE IN METALLO- FILO INOX

METAL SILENCERS
SILENCIEUX
SCHALLD-MPFER

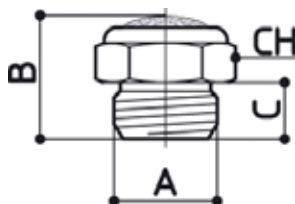

CODICE	A	B	C	D	E	F	G	CH	CH1	GR
SFE050	M5							8		2
SFE180	G1/8							13		6
SFE140	G1/4							16		11
SFE380	G3/8							19		15
SFE120	G1/2							24		24
SFE340	G3/4							30		39
SFE100	G1							36		41

SCQ

SILENZIATORE IN METALLO- SINTER.- QUADRO

METAL SILENCERS
SILENCIEUX
SCHALLD-MPFER

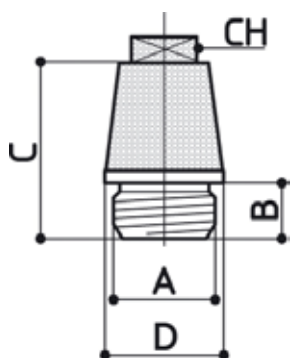

CODICE	A	B	C	D	E	F	G	CH	CH1	GR
SCQ180	G1/8									8
SCQ140	G1/4									14
SCQ120	G1/2									44
SCQ340	G3/4									82
SCQ380	G3/8									31
SCQ100	G1									159

SCT

SILENZIATORE IN METALLO- SINTER.- TAGLIO

METAL SILENCERS
SILENCIEUX
SCHALLD-MPFER

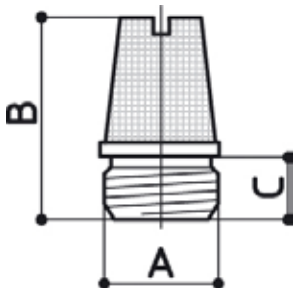

CODICE	A	B	C	D	E	F	G	CH	CH1	GR
SCT050	M5									2
SCT180	G1/8									8
SCT140	G1/4									12
SCT380	G3/8									25
SCT120	G1/2									49
SCT340	G3/4									74
SCT100	G1									138

SCE

SILENZIATORE IN METALLO- SINTER.- ESAGONO

METAL SILENCERS
SILENCIEUX
SCHALLD-MPFER

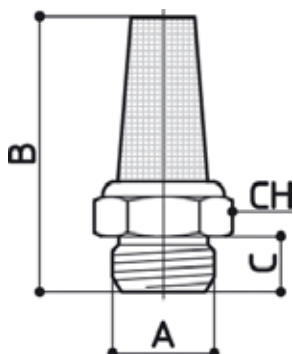

CODICE	A	B	C	D	E	F	G	CH	CH1	GR
SCE050	M5									2
SCE180	G1/8									8
SCE140	G1/4									16
SCE380	G3/8									29
SCE120	G1/2									46
SCE340	G3/4									88
SCE100	G1									149



SILENZIATORI

SILENCERS - SILENCIEUX - SCHALLDÄMPFER

SILENZIATORE IN METALLO- SINTER.- CON REGOLAZ. SVL

METAL SILENCERS
SILENCIEUX
SCHALLD-MPFER

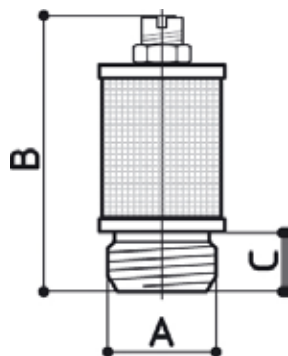

CODICE	A	B	C	D	E	F	G	CH	CH1	GR
SVL180	G1/8									32
SVL140	G1/4									36
SVL380	G3/8									30
SVL120	G1/2									84
SVL340	G3/4									/
SVL100	G1									/

SILENZIATORE IN METAL- SINTER.- REGOLAZ. MOLLA SVE

METAL SILENCERS
SILENCIEUX
SCHALLD-MPFER

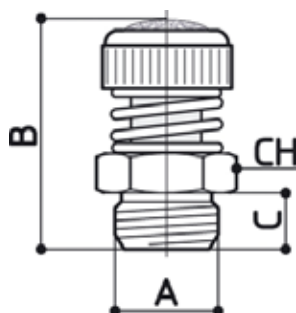

CODICE	A	B	C	D	E	F	G	CH	CH1	GR
SVE180	G1/8									16
SVE140	G1/4									23
SVE380	G3/8									51
SVE120	G1/2									63
SVE340	G3/4									134
SVE100	G1									/

SILENZIATORE IN PLASTICA - TAGLIO SPL

METAL SILENCERS
SILENCIEUX
SCHALLD-MPFER

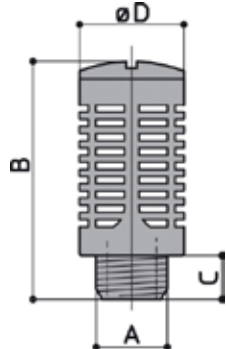

CODICE	A	B	C	D	E	F	G	CH	CH1	GR
SPL180	G1/8	32.5		15						5
SPL140	G1/4	43		19.5						9
SPL380	G3/8	58		24.5						16
SPL120	G1/2	58		24.5						18
SPL340	G3/4	115		48						107
SPL100	G1	115		48						119

SILENZIATORE IN PLASTICA - ESAGONO SPF

METAL SILENCERS
SILENCIEUX
SCHALLDÄMPFER

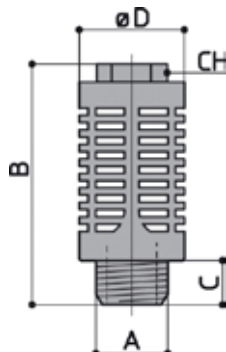
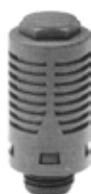

CODICE	A	B	C	D	E	F	G	CH	CH1	GR
SPF180	G1/8									3
SPF140	G1/4									4
SPF380	G3/8									11
SPF120	G1/2									9