

# REGOLATORI DI VELOCITA' SERIE CALZAMENTO PUSH-ON LINE FLOW REGULATORS

## CARATTERISTICHE TECNICHE PRINCIPALI MAIN TECHNICAL FEATURES

## HAUPTTECHNISCHE DATEN PRINCIPALES CARACTERISTIQUES TECHNIQUES

Corpo principale  
Main body

Attacco filettato  
Threaded connector

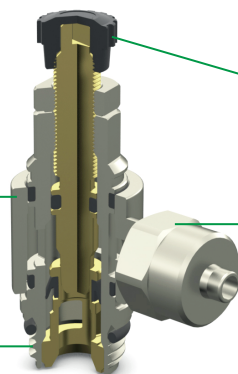

Registro di regolazione  
Register for regulation

Dado di bloccaggio  
Check nut

### MATERIALI DI COSTRUZIONE CONSTRUCTION MATERIALS

Ottone (EN 12164 - CW614N) Nichelato - Resine acetale - NBR  
Nickel plated brass (EN12164 - CW614N) Acetyl resin - NBR  
Messing Vernickelt (EN 12164 - CW614N) - Acetalharz - NBR  
Laiton (EN12164 - CW614N) Nickélé - Resine Acetal - NBR

### HERSTELLUNGSMATERIAL MATERIEL DE FABRICATION



-10°C (263 K)  
+80°C (353K)



MAX 10 BAR (1 MPa)

## TIPOLOGIE DI REGOLATORE FLOW REGULATORS TYPES

## DROSSELVERSCHRAUBUNG TYPEN TYPES DE REGULATEURS



Flusso libero - Free flow  
Freier fluss - Débit libre



Flusso regolato - Regulated flow  
Geregelter Durchfluss - Débit régulé

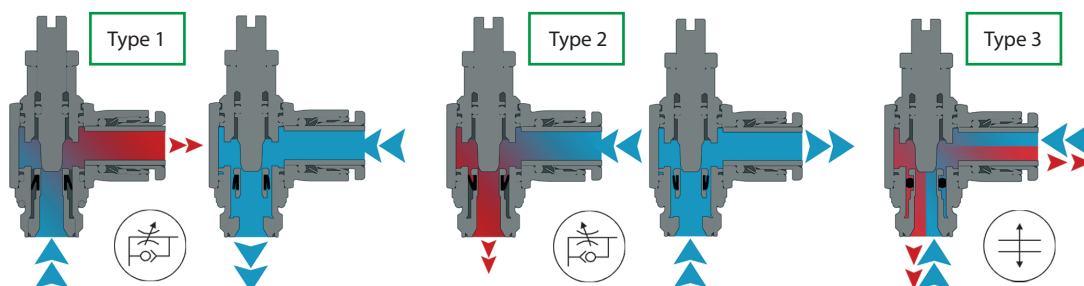

Regolatore per cilindro  
Regulator for cylinder  
Abluftdrossel für Zylinder  
Regulateur pour verin

Regolatore per valvola  
Regulator for valve  
Abluftdrossel für Ventil  
Regulateur pour vanne

Regolatore bidirezionale  
Regulator bidirectional  
Beidseitig wirkendedrossel  
Regulateur bidirectionnel

## REGOLATORI DI VELOCITA' SERIE CALZAMENTO PUSH-ON LINE FLOW REGULATORS

### TIPI DI TUBO INNESTABILI SUITABLE FOR

Rilsan (PA11/12), Poliuretano, Polietilene, Poliestere, Teflon, Nylon (PA6):  $\pm 0,05$  ( $\varnothing 4 \div \varnothing 10$ ) -  $\pm 0,1$  ( $\varnothing 12 \div \varnothing 14$ )  
 Rilsan (PA11/12), Polyurethane, Polyethylene, Polyester, Teflon, Nylon (PA6):  $\pm 0,05$  ( $\varnothing 4 \div \varnothing 10$ ) -  $\pm 0,1$  ( $\varnothing 12 \div \varnothing 14$ )  
 Rilsan (PA11/12), Polyurethan, Polyätylen, Polyester, Teflon, Nylon (PA6):  $\pm 0,05$  ( $\varnothing 4 \div \varnothing 10$ ) -  $\pm 0,1$  ( $\varnothing 12 \div \varnothing 14$ )  
 Rilsan (PA11/12), Polyuréthane, Polyéthylène, Polyester, Téflon, Nylon (PA6):  $\pm 0,05$  ( $\varnothing 4 \div \varnothing 10$ ) -  $\pm 0,1$  ( $\varnothing 12 \div \varnothing 14$ )

### SCHLAUCHTYPEN

### TYPES DE TUBES D'ACCOUPEMENT

### O-RING/GUARNIZIONI O-RING/RUBBER-GASKET

Guarnizioni in gomma antiolio NBR, esenti silicone  
 Oil-proof rubber packings NBR, silicon free

### DICHTUNGEN JOINTS

Dichtungen NBR, Ölbestanding, silikonfrei  
 Joints en caoutchouc anti-huile NBR, libres de silicone

### CARATTERISTICHE DELLA FILETTATURA EASY EASY THREAD FEATURES

### EASY BAUREIHE GEWINDE DATEN CARACTERISTIQUES FILETAGE SERIE EASY

Il sistema **brevettato** di tenuta con O-RING tipo EASY assicura il **MINIMO INGOMBRO DELLA CHIAVE** esagonale esterna e garantisce applicazioni sicure su **sedi filettate** imperfette con: 1=**SMUSSO GRANDE** d'invito del filetto femmina - 2=**SMUSSO PICCOLO** d'invito del filetto femmina - 3=filettatura su **SUPERFICI CURVE** - 4=filettatura **NON PERPENDICOLARE** al piano di posa

The **patented** seal system with O-RING on the thread EASY type ensures the **MINIMUM HINDRANCE OF THE HEXAGONAL KEY** and grants sure applications on imperfect threaded seats with: 1=**BIG INVITATION CHAMFER** of the female thread - 2=**SMALL INVITATION CHAMFER** of the female thread - 3=thread on **CURVED SURFACES** - 4=thread **NOT PERPENDICULAR** to the substructure

Das **patentierte** Dichtungssystem mit O-RING Easy-Schraubverbindung ermöglicht eine Abdichtung auch bei **UNVOLLSTÄNDIGEM GEWINDE** mit: 1=Innengewinde mit **GROSSER SENKUNG** - 2=Innengewinde mit **GERINGER SENKUNG** 3=Gewindeschneiden an **KURVE FLACHE** - 4=Innengewinde **MIT NEIGUNG** zur oberfläche.

Le système **breveté** d'étancheité avec O-RING sur le filetage assure le **MINIMUM ENCOMBREMENT DE LA CLEF HEXAGONALE EXTÉRIEURE** et il garanti appllications sûres sur **SIÈGES FILETÉES IMPARFAITES** avec: 1=Arrondissement **GRAND D'INVITATION** sur le filetage femelle - 2=Arrondissement **PETIT D'INVITATION** sur le filetage femelle - 3=Filetage sur **SURFACES COURBES** - 4=Filetage **PAS PERPENDICULAIRE** au plan de pose



### CODIFICA REGOLATORI SERIE CALZAMENTO

### BESTELLNUMMERSYSTEM SCHENLLVERSCRAUBUNGEN

### PUSH-ON LINE REGULATOR CODING

### CODIFICATION REGULATEURS RAPIDES

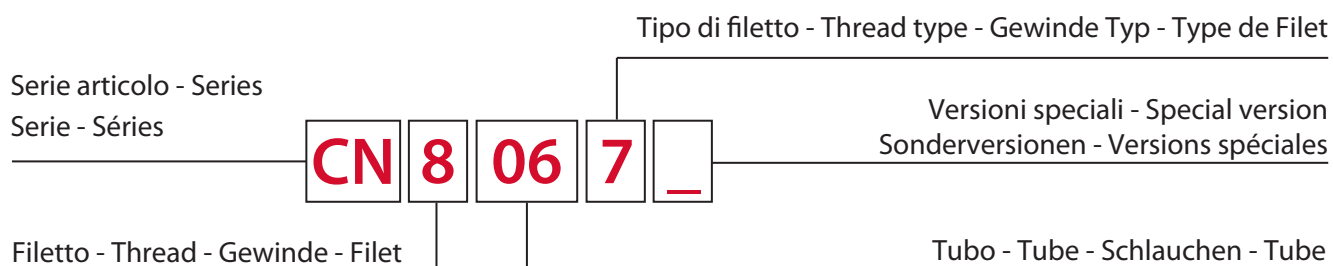

# GRAFICI DI PORTATA FLOW CHARTS

CD - CR - CN

CILINDRICO+OR/TUBO CALZAMENTO

ZYLINDRISCH+OR, FÜR SCHALUCH,  
SCHELLVERSCRAUBUNGEN

PARALLEL+OR/TUBE PUSH-ON

CILINDRIQUE+OR, TUBO, RAPIDE

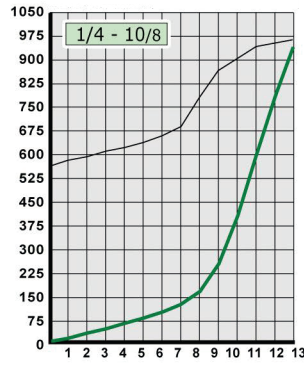
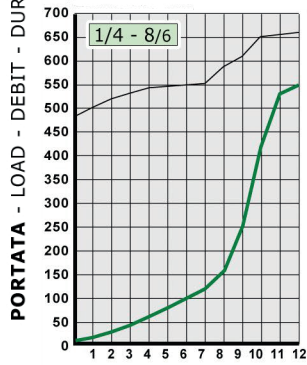
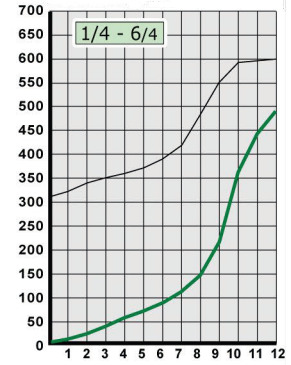
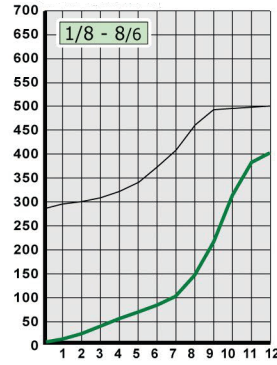
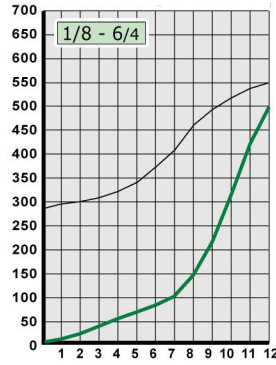
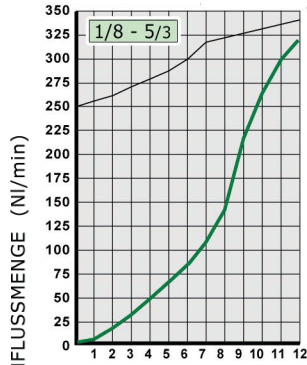

PORTATE A 6 BAR  
FLOW RATE AT 6 BAR

GIRI DEL REGISTRO - REGISTER TURNS - TOURS DE LA VIS DE REGLAGE - ANZAHL DREHUNGEN