

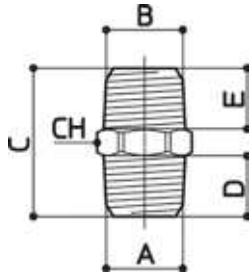

S10

NIPPLO CONICO
TAPERED NIPPLE



CODICE	A	B	C	D	E	CH	GR
S10880	R1/8	R1/8	21	8	8	12	9
S10840	R1/8	R1/4	23	8	10	14	14
S10440	R1/4	R1/4	27	11	11	14	14
S10830	R1/8	R3/8	25	8	11	17	20
S10430	R1/4	R3/8	27	10	11	17	24
S10330	R3/8	R3/8	27	11	11	17	26
S10420	R1/4	R1/2	30	10	14	22	36
S10320	R3/8	R1/2	31	11	14	22	39
S10220	R1/2	R1/2	34	14	14	22	42
S10270	R1/2	R3/4	37	14	16.5	27	67
S10770	R3/4	R3/4	39.5	16.5	16.5	27	80
S10710	R3/4	R1	42.5	16.5	19	34	105
S10110	R1	R1	45	19	19	34	127

S11

NIPPLO CILINDRICO
PARALLEL NIPPLE

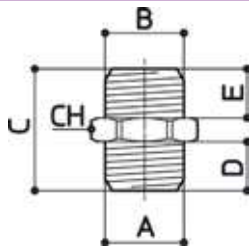

CODICE	A	B	C	D	E	CH	GR
S11580	M5	G1/8	14.5	4	6	14	9
S11880	G1/8	G1/8	16.5	6	6	14	10
S11840	G1/8	G1/4	19	6	8	17	15
S11440	G1/4	G1/4	21	8	8	17	17
S11830	G1/8	G3/8	22	6	10	20	25
S11430	G1/4	G3/8	24	8	10	20	25
S11330	G3/8	G3/8	26	10	10	20	28
S11420	G1/4	G1/2	26	8	12	24	36
S11320	G3/8	G1/2	28	10	12	24	39
S11220	G1/2	G1/2	25.5	10	10	24	35
S11270	G1/2	G3/4	27.5	10	11	30	66
S11770	G3/4	G3/4	28.5	11	11	30	60

S12

PROLUNGA CONICA
TAPERED EXTENSION

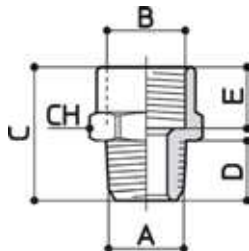

CODICE	A	B	C	D	E	CH	GR
S12880	R1/8	G1/8	20	8	8	14	12
S12480	R1/4	G1/8	23	10	8	17	15
S12840	R1/8	G1/4	23	8	10	17	18
S12440	R1/4	G1/4	24	10	10	17	19
S12340	R3/8	G1/4	25	11	10	22	39
S12830	R1/8	G3/8	23	8	11	22	30
S12430	R1/4	G3/8	25	10	11	22	31
S12330	R3/8	G3/8	27	11	11	22	35
S12230	R1/2	G3/8	32	14	11	22	43
S12420	R1/4	G1/2	29	10	13	24	38
S12320	R3/8	G1/2	30	11	13	26	52
S12220	R1/2	G1/2	33	14	13	26	54
S12270	R1/2	G3/4	35	14	16.5	32	82